

CODIGO **15782, 15783, 22398**

DESCRIPCION: **FILTRO CANTABRIC 400 500 600**

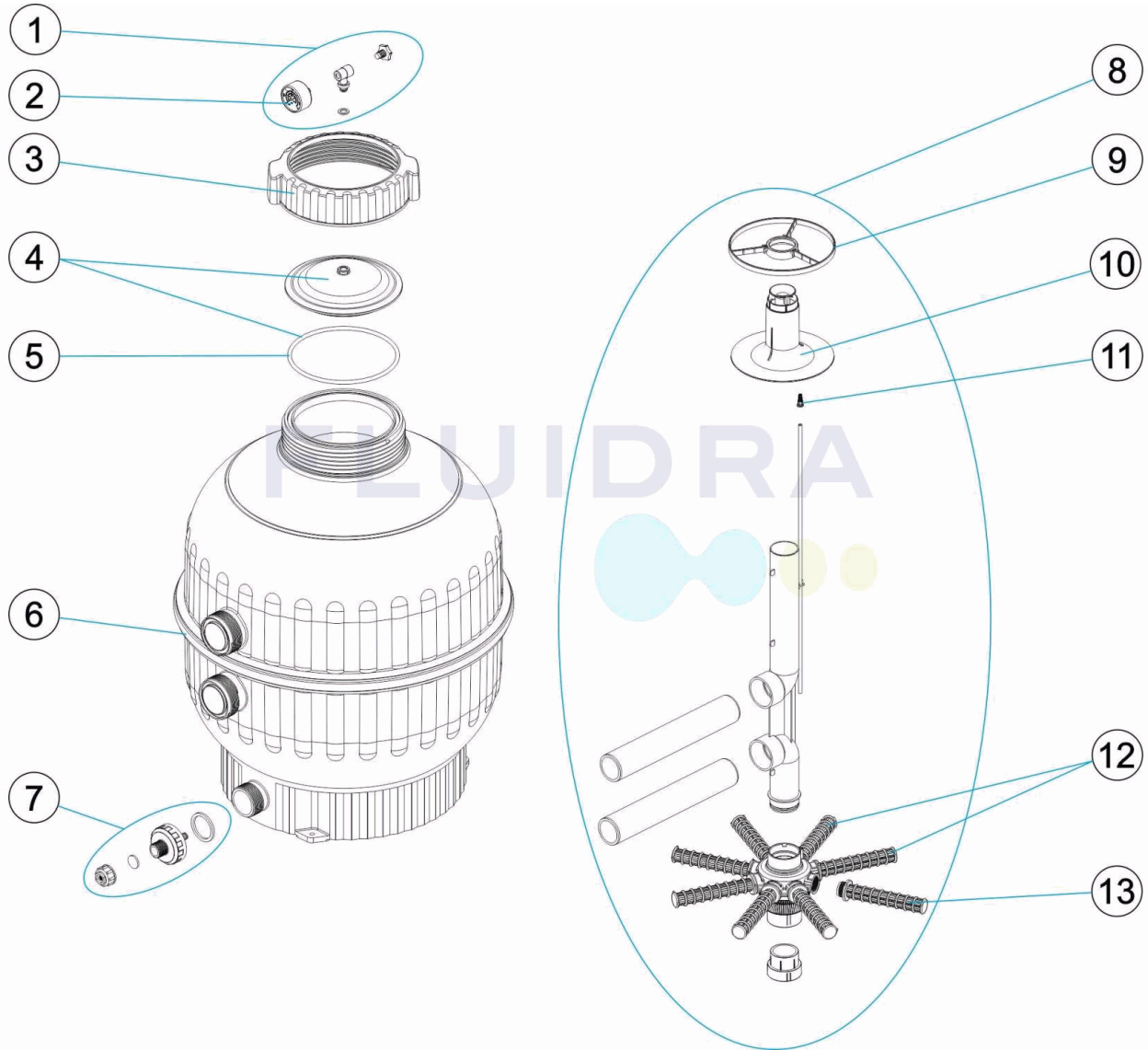

**ESPAÑOL**

| POS | CODIGO     | DESCRIPCION                                 | POS | CODIGO       | DESCRIPCION                        |
|-----|------------|---|-----|--------------|------------------------------------|
| 1   | 4404080104 | MANOMETRO COMPLETO                          | 8   | * 4404180016 | CJTO. INTERIOR CTB D. 600          |
| 2   | 4404010103 | MANOMETRO 1/8" 3 KG./C "                    | 9   | 4404180106   | ANILLO CENTRADOR                   |
| 3   | 4404180007 | TUERCA TAPA CANTABRIC                       | 10  | 4404180025   | DIFUSOR D.400 - 600                |
| 4   | 4404180101 | TAPA TRANSPARENTE EASTAR D.173 (PCTA) + JUN | 11  | 4404040108   | PURGA AIRE                         |
| 5   | 4404180201 | JUNTA TORICA                                | 12  | * 4404010073 | CJTO. BRAZOS COLECTOR D. 350 - 400 |
| 6 * | 4404180017 | PERFIL EMBELLECEDOR D. 400                  | 12  | * 4404010074 | CJTO. BRAZOS COLECTOR D. 450 - 500 |
| 6 * | 4404180018 | PERFIL EMBELLECEDOR D. 500                  | 12  | * 4404010075 | CJTO. BRAZOS COLECTOR D. 600       |
| 6 * | 4404180019 | PERFIL EMBELLECEDOR D. 600                  | 13  | * 4404300119 | BRAZO COLECTOR 3/4" 110 M "        |
| 7   | 4404180110 | PURGA ARENA 1 1/2'                          | 13  | * 4404300120 | BRAZO COLECTOR 3/4" 160 M "        |
| 8 * | 4404180014 | CJTO. INTERIOR CTB 400                      | 13  | * 4404300712 | BRAZO COLECTOR 3/4" 225M "         |
| 8 * | 4404180015 | CJTO. INTERIOR CTB D. 500                   |     |              |                                    |

**CODIGO 15782, 15783, 22398**

**DESCRIPCION: FILTRO CANTABRIC 400 500 600**

## OBSERVACIONES

| POS | CODIGO     | OBSERVACIONES     |
|-----|------------|-------------------|
| 6   | 4404180017 | PARA: 15782       |
| 6   | 4404180018 | PARA: 15783       |
| 6   | 4404180019 | PARA: 22398       |
| 8   | 4404180014 | PARA: 22398       |
| 8   | 4404180015 | PARA: 15782       |
| 8   | 4404180016 | PARA: 15783       |
| 12  | 4404010073 | PARA: 22398       |
| 12  | 4404010074 | PARA: 15782       |
| 12  | 4404010075 | PARA: 15783       |
| 13  | 4404300119 | PARA: 22398 [4UT] |
| 13  | 4404300120 | PARA: 15782 [4UT] |
| 13  | 4404300712 | PARA: 15783 [4UT] |

CODE **15782, 15783, 22398**

DESCRIPTION: **FILTRE CANTABRIC 400 500 600**

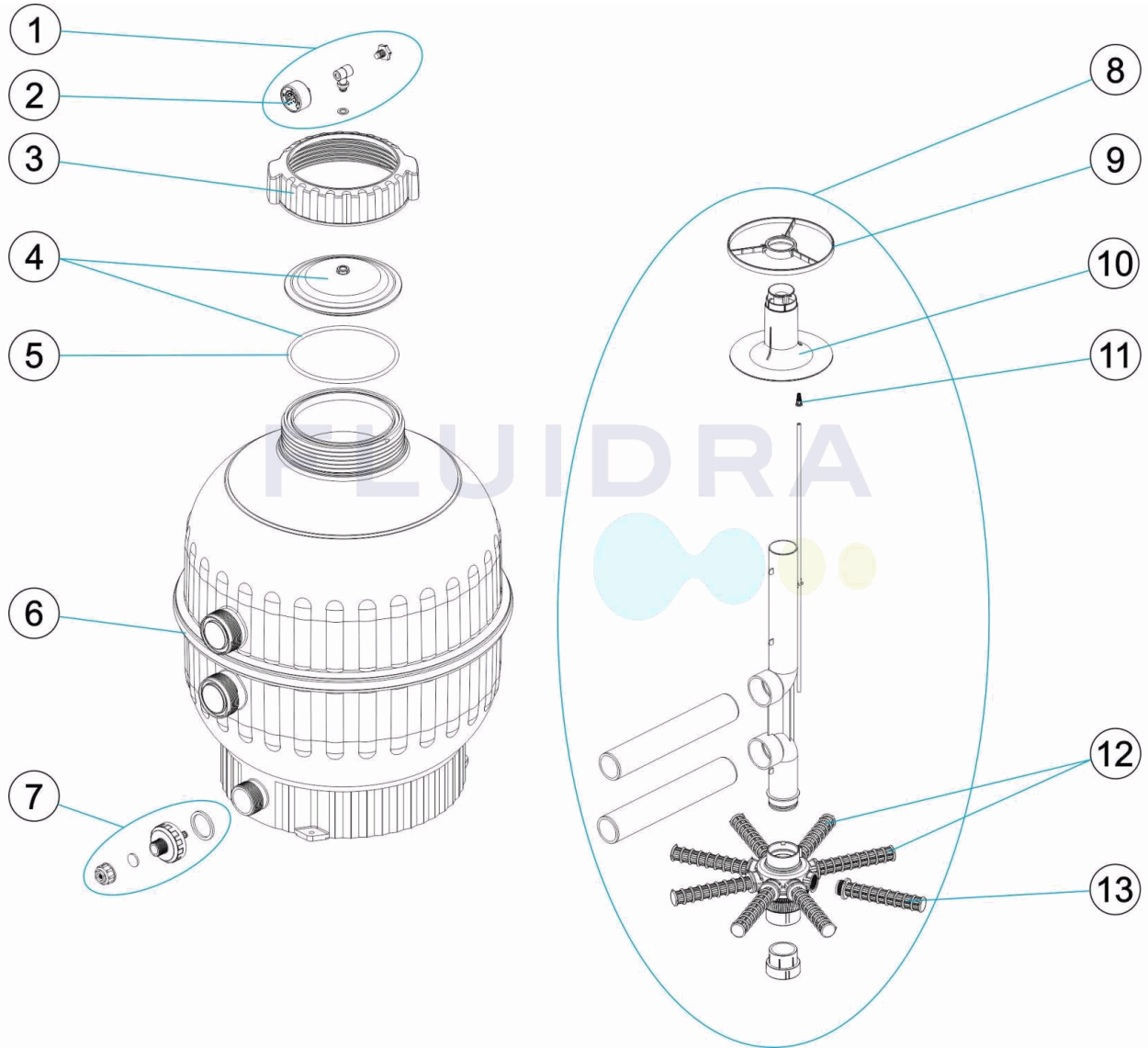

**FRANCAIS**

| POS | CODE         | DESCRIPTION                                | POS | CODE         | DESCRIPTION                               |
|-----|--------------|--|-----|--------------|---|
| 1   | 4404080104   | MANOMETRE COMPLET                          | 8   | * 4404180016 | ENSEMBLE INTERIEUR D. 600                 |
| 2   | 4404010103   | MANOMETRE 1/8" 3 KG./C "                   | 9   | 4404180106   | DISQUE CENTREUR                           |
| 3   | 4404180007   | ECROU DE COUVERCLE CANTABRIC               | 10  | 4404180025   | DIFUSOR D.400 - 600                       |
| 4   | 4404180101   | COUVERCLE TRANSPARENT " EASTAR" D.173 + JO | 11  | 4404040108   | PURGE D'AIR                               |
| 5   | 4404180201   | JOINT TORIQUE                              | 12  | * 4404010073 | ENSEMBLE BRAS DE REPARTITEUR D. 350       |
| 6   | * 4404180017 | ANNEAU DE PROTECTION D. 400                | 12  | * 4404010074 | ENSEMBLE BRAS DE REPARTITEUR D. 450 - 500 |
| 6   | * 4404180018 | ANNEAU DE PROTECTION D. 500                | 12  | * 4404010075 | ENSEMBLE BRAS DE REPARTITEUR D. 600       |
| 6   | * 4404180019 | ANNEAU DE PROTECTION D. 600                | 13  | * 4404300119 | BRAS DE REPARTITEUR 3/4" 110M "           |
| 7   | 4404180110   | PURGE SABLE 1 1/2"                         | 13  | * 4404300120 | BRAS DE REPARTITEUR 3/4" 160M "           |
| 8   | * 4404180014 | ENSEMBLE INTERIEUR D400                    | 13  | * 4404300712 | BRAS DE REPARTITEUR 3/4" 225M "           |
| 8   | * 4404180015 | ENSEMBLE INTERIEUR D. 500                  |     |              |   |

CODE **15782, 15783, 22398**

DESCRIPTION: **FILTRE CANTABRIC 400 500 600**

## OBSERVATIONS

| POS | CODE       | OBSERVATIONS      |
|-----|------------|-------------------|
| 6   | 4404180017 | POUR: 15782       |
| 6   | 4404180018 | POUR: 15783       |
| 6   | 4404180019 | POUR: 22398       |
| 8   | 4404180014 | POUR: 22398       |
| 8   | 4404180015 | POUR: 15782       |
| 8   | 4404180016 | POUR: 15783       |
| 12  | 4404010073 | POUR: 22398       |
| 12  | 4404010074 | POUR: 15782       |
| 12  | 4404010075 | POUR: 15783       |
| 13  | 4404300119 | POUR: 22398 [4UT] |
| 13  | 4404300120 | POUR: 15782 [4UT] |
| 13  | 4404300712 | POUR: 15783 [4UT] |

CODE **15782, 15783, 22398**

DESCRIPTION: **CANTABRIC FILTER 400 500 600**

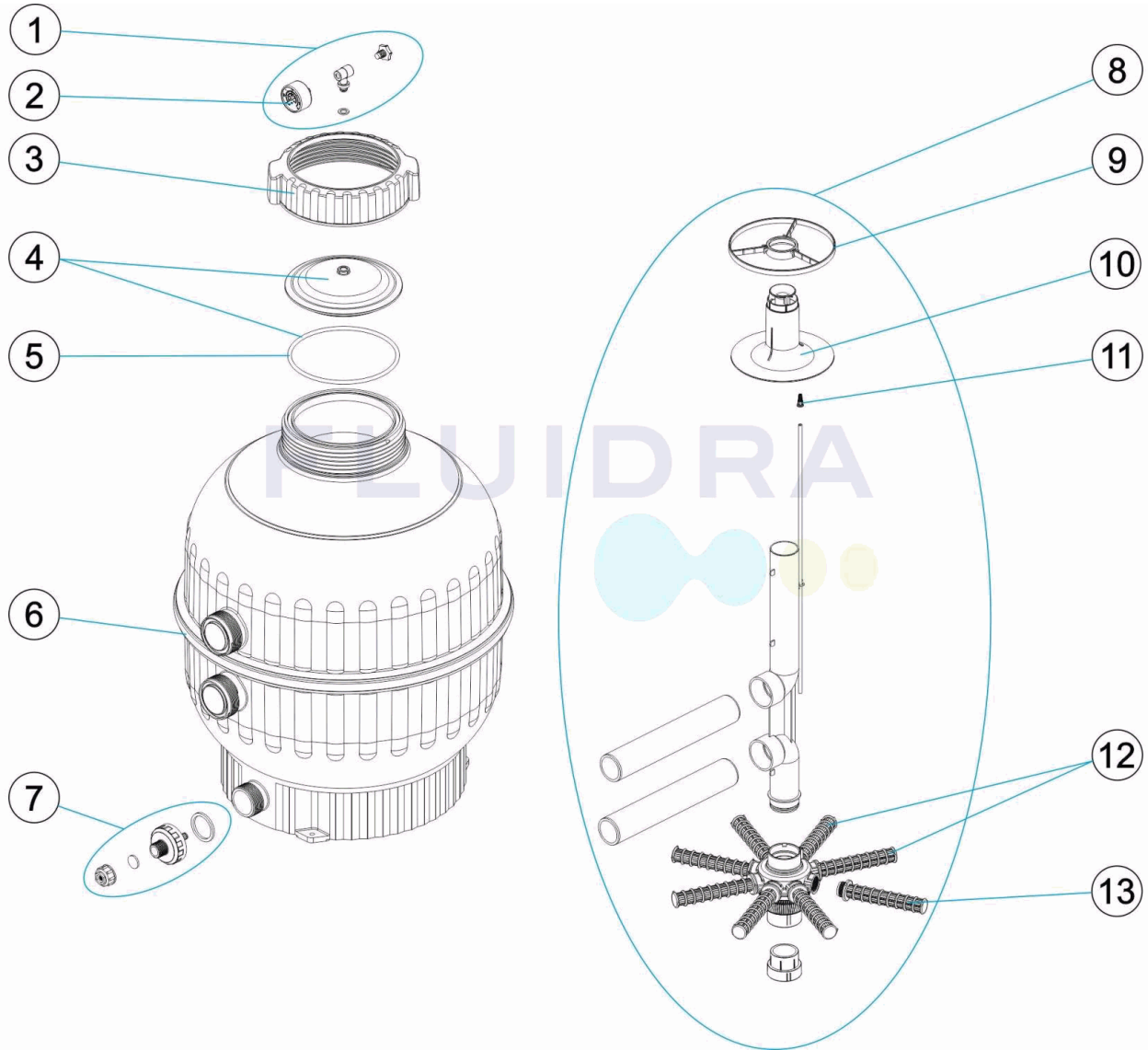

**ENGLISH**

| POS | CODE         | DESCRIPTION                                 | POS | CODE         | DESCRIPTION                         |
|-----|--------------|---|-----|--------------|-------------------------------------|
| 1   | 4404080104   | COMPLETE PRESSURE GAUGE UNIT                | 8   | * 4404180016 | COLLECTOR ASSEMBLY CANTABRIC D. 600 |
| 2   | 4404010103   | PRESSURE GAUGE 1/8" 3 KG./C "               | 9   | 4404180106   | CENTERING RING                      |
| 3   | 4404180007   | THREADED LID COLLAR CANTABRIC               | 10  | 4404180025   | D.400 - 600 DIFFUSER                |
| 4   | 4404180101   | TRANSPARENT LID " EASTAR" D.173 + 'O' RIN " | 11  | 4404040108   | AIR PURGE                           |
| 5   | 4404180201   | O' RING                                     | 12  | * 4404010073 | MANIFOLD ARM ASSEMBLY D. 350        |
| 6   | * 4404180017 | PROFILE FACEPLATE D. 400                    | 12  | * 4404010074 | MANIFOLD ARM ASSEMBLY D. 450 - 500  |
| 6   | * 4404180018 | PROFILE FACEPLATE D. 500                    | 12  | * 4404010075 | MANIFOLD ARM ASSEMBLY D. 600        |
| 6   | * 4404180019 | PROFILE FACEPLATE D. 600                    | 13  | * 4404300119 | MANIFOLD ARM 3/4" 110 M "           |
| 7   | 4404180110   | SAND PURGE 1 "                              | 13  | * 4404300120 | MANIFOLD ARM 3/4" 160 M "           |
| 8   | * 4404180014 | COLLECTOR ASSEMBLY CANTABRIC D. 400         | 13  | * 4404300712 | MANIFOLD ARM 3/4" 225 M "           |
| 8   | * 4404180015 | COLLECTOR ASSEMBLY CANTABRIC D. 500         |     |              |                                     |

CODE **15782, 15783, 22398**

DESCRIPTION: **CANTABRIC FILTER 400 500 600**

## OBSERVATIONS

| POS | CODE       | OBSERVATIONS     |
|-----|------------|------------------|
| 6   | 4404180017 | FOR: 15782       |
| 6   | 4404180018 | FOR: 15783       |
| 6   | 4404180019 | FOR: 22398       |
| 8   | 4404180014 | FOR: 22398       |
| 8   | 4404180015 | FOR: 15782       |
| 8   | 4404180016 | FOR: 15783       |
| 12  | 4404010073 | FOR: 22398       |
| 12  | 4404010074 | FOR: 15782       |
| 12  | 4404010075 | FOR: 15783       |
| 13  | 4404300119 | FOR: 22398 [4UT] |
| 13  | 4404300120 | FOR: 15782 [4UT] |
| 13  | 4404300712 | FOR: 15783 [4UT] |

CODICE 15782, 15783, 22398

DESCRIZIONE: FILTRO CANTABRIC 400 500 600

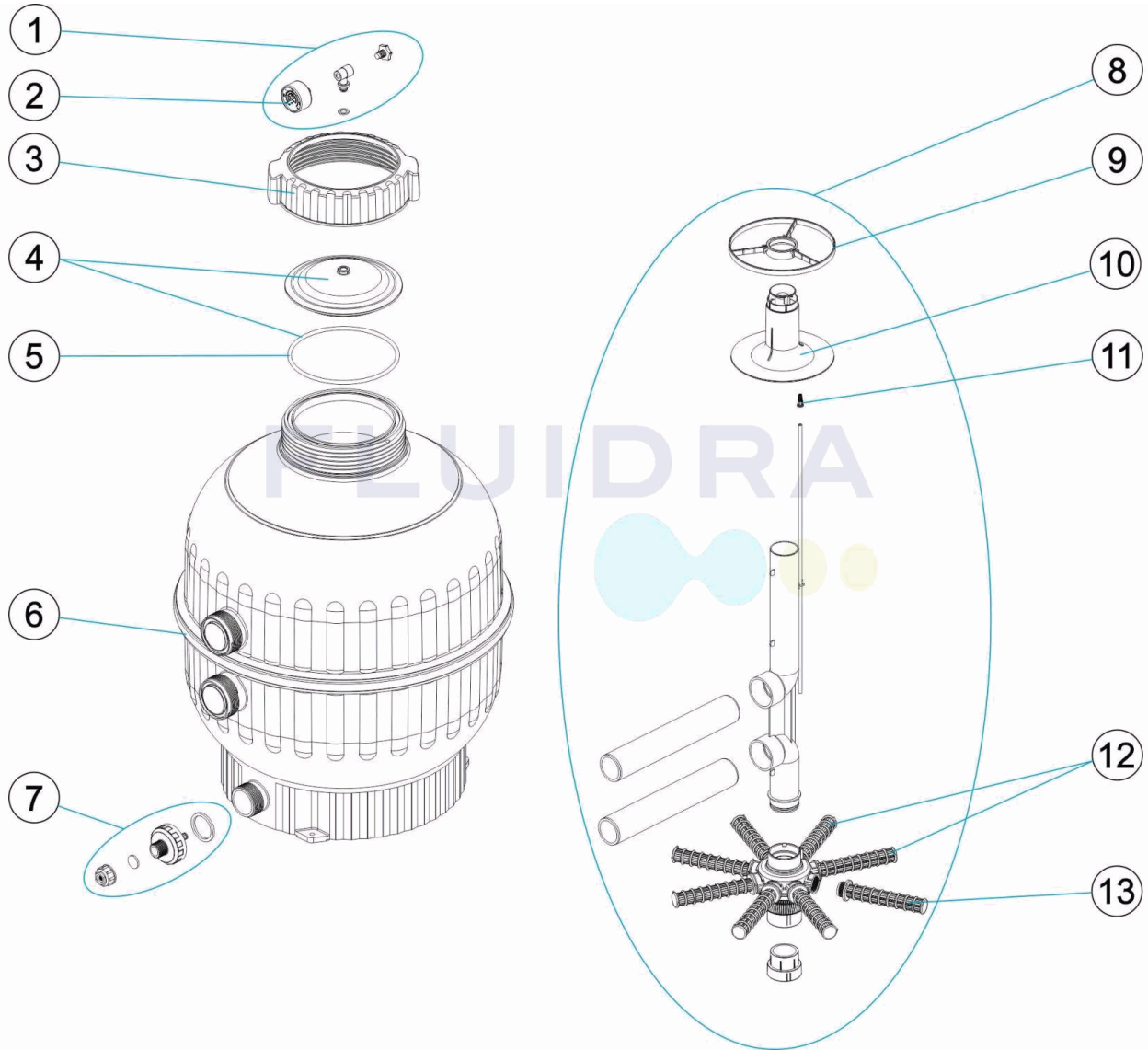

ITALIANO

| POS | CODICE       | DESCRIZIONE                               | POS | CODICE       | DESCRIZIONE                               |
|-----|--------------|---|-----|--------------|---|
| 1   | 4404080104   | MANOMETRO COMPLETO                        | 8   | * 4404180016 | KIT COLLETTORE CANTABRIC D. 600           |
| 2   | 4404010103   | MANOMETRO 1/8" 3 KG./C "                  | 9   | 4404180106   | ANELLO CENTRAGGIO                         |
| 3   | 4404180007   | GHIERA COPERCHIO CANTABRIC                | 10  | 4404180025   | DIFFUSORE D.400 - 600                     |
| 4   | 4404180101   | COPERCHIO TRASPARENTE " EASTAR" D.173 + C | 11  | 4404040108   | SFIATO ARIA                               |
| 5   | 4404180201   | O-RING                                    | 12  | * 4404010073 | GRUPPO CANDELOTTO COLLETTORE D. 350       |
| 6   | * 4404180017 | PROFILO FLANGIA D. 400                    | 12  | * 4404010074 | GRUPPO CANDELOTTO COLLETTORE D. 450 - 500 |
| 6   | * 4404180018 | PROFILO FLANGIA D. 500                    | 12  | * 4404010075 | GRUPPO CANDELOTTO COLLETTORE D. 600       |
| 6   | * 4404180019 | PROFILO FLANGIA D. 600                    | 13  | * 4404300119 | CANDELOTTO COLLETTORE 3/4" 110M "         |
| 7   | 4404180110   | SCARICO SABBIA 1 "                        | 13  | * 4404300120 | CANDELOTTO COLLETTORE 3/4" 160M "         |
| 8   | * 4404180014 | KIT COLLETTORE CANTABRIC D. 400           | 13  | * 4404300712 | CANDELOTTO COLLETTORE 3/4" 225M "         |
| 8   | * 4404180015 | KIT COLLETTORE CANTABRIC D. 500           |     |              |   |

**CODICE 15782, 15783, 22398**

**DESCRIZIONE: FILTRO CANTABRIC 400 500 600**

## OSSERVAZIONI

| POS | CODICE     | OSSERVAZIONI     |
|-----|------------|------------------|
| 6   | 4404180017 | PER: 15782       |
| 6   | 4404180018 | PER: 15783       |
| 6   | 4404180019 | PER: 22398       |
| 8   | 4404180014 | PER: 22398       |
| 8   | 4404180015 | PER: 15782       |
| 8   | 4404180016 | PER: 15783       |
| 12  | 4404010073 | PER: 22398       |
| 12  | 4404010074 | PER: 15782       |
| 12  | 4404010075 | PER: 15783       |
| 13  | 4404300119 | PER: 22398 [4UT] |
| 13  | 4404300120 | PER: 15782 [4UT] |
| 13  | 4404300712 | PER: 15783 [4UT] |



CODE **15782, 15783, 22398**

BESCHREIBUNG: **FILTER CANTABRIC 400 500 600**

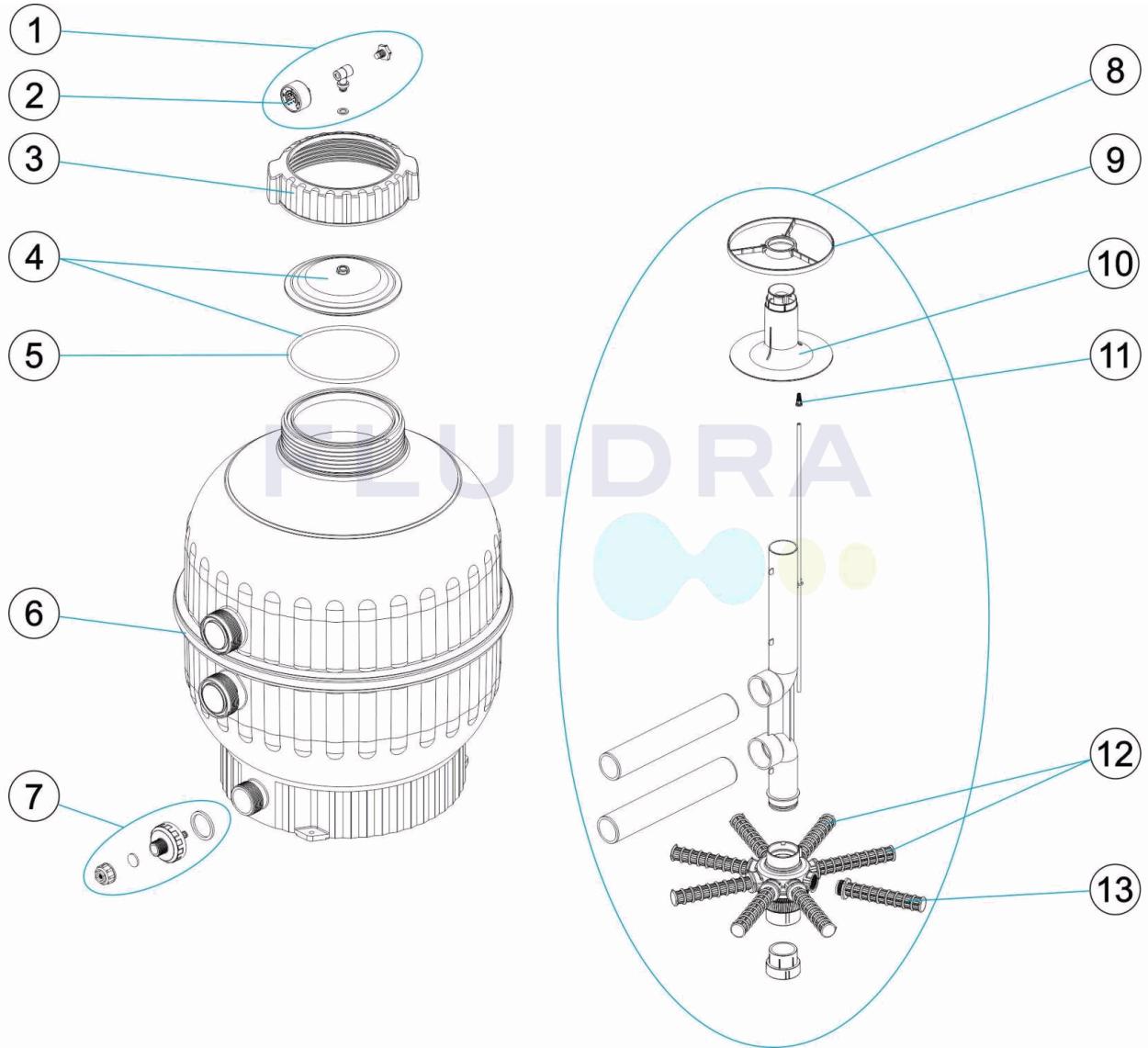

**DEUTSCH**

| POS | CODE         | BESCHREIBUNG                                  | POS | CODE         | BESCHREIBUNG                             |
|-----|--------------|---|-----|--------------|--|
| 1   | 4404080104   | MANOMETER KOMPLETT                            | 8   | * 4404180016 | SAMMELROHRSET CTB D. 600                 |
| 2   | 4404010103   | MANOMETER 1/8" 3 KG/C "                       | 9   | 4404180106   | ZENTRIERING                              |
| 3   | 4404180007   | MUTTER ABDECKUNG CANTABRIC                    | 10  | 4404180025   | WASSERVERTEILER D.400 - 600              |
| 4   | 4404180101   | ABDECKUNG TRANSPARENT D.173 PCTA UND DICHTUNG | 11  | 4404040108   | ENTLÜFTUNG                               |
| 5   | 4404180201   | O-RING  | 12  | * 4404010073 | SET FILTERSTERN-SCHLITZROHR D. 350 - 400 |
| 6   | * 4404180017 | PROFIL BLENDE D. 400                          | 12  | * 4404010074 | SET FILTERSTERN-SCHLITZROHR D. 450 - 500 |
| 6   | * 4404180018 | PROFIL BLENDE D. 500                          | 12  | * 4404010075 | SET FILTERSTERN-SCHLITZROHR D. 600       |
| 6   | * 4404180019 | PROFIL BLENDE D. 600                          | 13  | * 4404300119 | FILTERSTERN-SCHLITZROHR 3/4" 110M "      |
| 7   | 4404180110   | SANDENTLEERUNG 1 1/2'                         | 13  | * 4404300120 | FILTERSTERN-SCHLITZROHR 3/4" 160 M "     |
| 8   | * 4404180014 | SAMMELROHRSET CTB 400                         | 13  | * 4404300712 | FILTERSTERN-SCHLITZROHR 3/4" 225M "      |
| 8   | * 4404180015 | SAMMELROHRSET CTB D. 500                      |     |              |  |

CODE **15782, 15783, 22398**

BESCHREIBUNG: **FILTER CANTABRIC 400 500 600**

## HINWEISE

| POS | CODE       | HINWEISE         |
|-----|------------|------------------|
| 6   | 4404180017 | FÜR: 15782       |
| 6   | 4404180018 | FÜR: 15783       |
| 6   | 4404180019 | FÜR: 22398       |
| 8   | 4404180014 | FÜR: 22398       |
| 8   | 4404180015 | FÜR: 15782       |
| 8   | 4404180016 | FÜR: 15783       |
| 12  | 4404010073 | FÜR: 22398       |
| 12  | 4404010074 | FÜR: 15782       |
| 12  | 4404010075 | FÜR: 15783       |
| 13  | 4404300119 | FÜR: 22398 [4UT] |
| 13  | 4404300120 | FÜR: 15782 [4UT] |
| 13  | 4404300712 | FÜR: 15783 [4UT] |

CODIGO **15782, 15783, 22398**

DESCRIÇÃO: **FILTRO CANTABRIC 400 500 600**

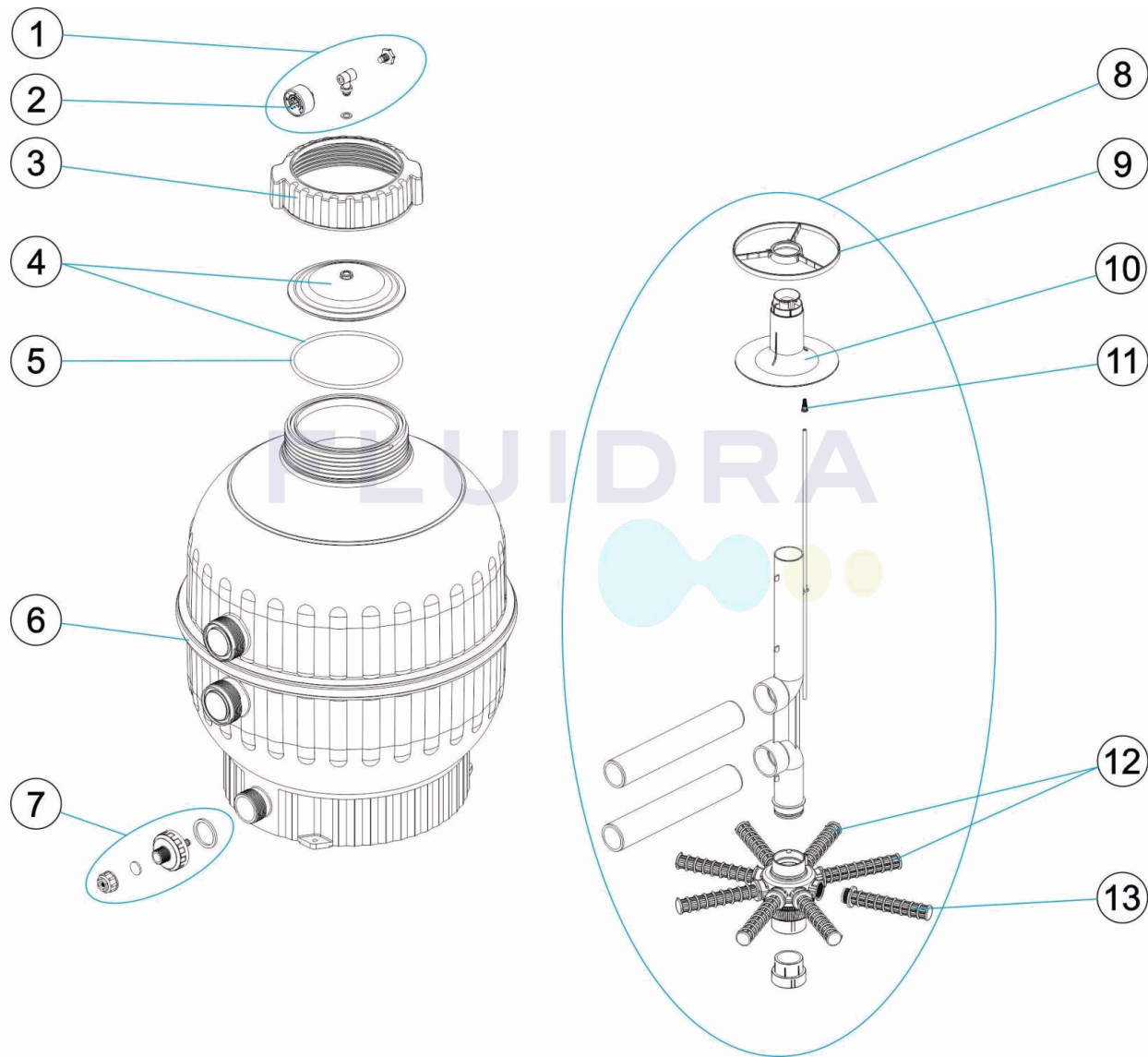

**PORTUGUES**

| POS | CODIGO       | DESCRIÇÃO                                   | POS | CODIGO       | DESCRIÇÃO                          |
|-----|--------------|---|-----|--------------|------------------------------------|
| 1   | 4404080104   | MANÓMETRO COMPLETO                          | 8   | * 4404180016 | CONJUNTO COLECTOR CANTABRIC D. 600 |
| 2   | 4404010103   | MANOMETRO 1/8" 3 KG./C "                    | 9   | 4404180106   | ARO CENTRADOR                      |
| 3   | 4404180007   | PORCA TAMPA CANTABRIC                       | 10  | 4404180025   | DIFUSOR D.400 - 600                |
| 4   | 4404180101   | TAMPA TRANSPARENTE " EASTAR" D.173 + JUNT " | 11  | 4404040108   | PURGA AREIA                        |
| 5   | 4404180201   | JUNTA TÓRICA                                | 12  | * 4404010073 | CJTO. BRAÇO COLECTOR D. 350        |
| 6   | * 4404180017 | PERFIL EMBELEZADOR D. 400                   | 12  | * 4404010074 | CJTO. BRAÇO COLECTOR D. 450 - 500  |
| 6   | * 4404180018 | PERFIL EMBELEZADOR D. 500                   | 12  | * 4404010075 | CJTO. BRAÇO COLECTOR D. 600        |
| 6   | * 4404180019 | PERFIL EMBELEZADOR D. 600                   | 13  | * 4404300119 | BRAÇO COLECTOR 3/4" 110M "         |
| 7   | 4404180110   | PURGA AREIA 1 "                             | 13  | * 4404300120 | BRAÇO COLECTOR 3/4" 160M "         |
| 8   | * 4404180014 | CONJUNTO COLECTOR CANTABRIC D. 400          | 13  | * 4404300712 | BRAÇO COLECTOR 3/4" 225M "         |
| 8   | * 4404180015 | CONJUNTO COLECTOR CANTABRIC D. 500          |     |              |                                    |

**CODIGO 15782, 15783, 22398**

**DESCRIÇÃO: FILTRO CANTABRIC 400 500 600**

## OBSERVACÕES

| POS | CODIGO     | OBSERVACÕES       |
|-----|------------|-------------------|
| 6   | 4404180017 | PARA: 15782       |
| 6   | 4404180018 | PARA: 15783       |
| 6   | 4404180019 | PARA: 22398       |
| 8   | 4404180014 | PARA: 22398       |
| 8   | 4404180015 | PARA: 15782       |
| 8   | 4404180016 | PARA: 15783       |
| 12  | 4404010073 | PARA: 22398       |
| 12  | 4404010074 | PARA: 15782       |
| 12  | 4404010075 | PARA: 15783       |
| 13  | 4404300119 | PARA: 22398 [4UT] |
| 13  | 4404300120 | PARA: 15782 [4UT] |
| 13  | 4404300712 | PARA: 15783 [4UT] |